

# BERKELEY® B3ZRM

## Cast Iron Impeller

Threaded Case (NPT), Packing Construction

### BEARING FRAME MOUNT

Section	FM
Page	130.6.3
Date	March 4, 2013
Supersedes 09/21/12	

**Table I**

B/M No.	Rotation	Volute Case	Impeller	Impeller Diameter
<b>B85874</b>	CCW	H00698	M14989	9.00"
<b>B86070</b>	CW	H00689	M14994	9.00"

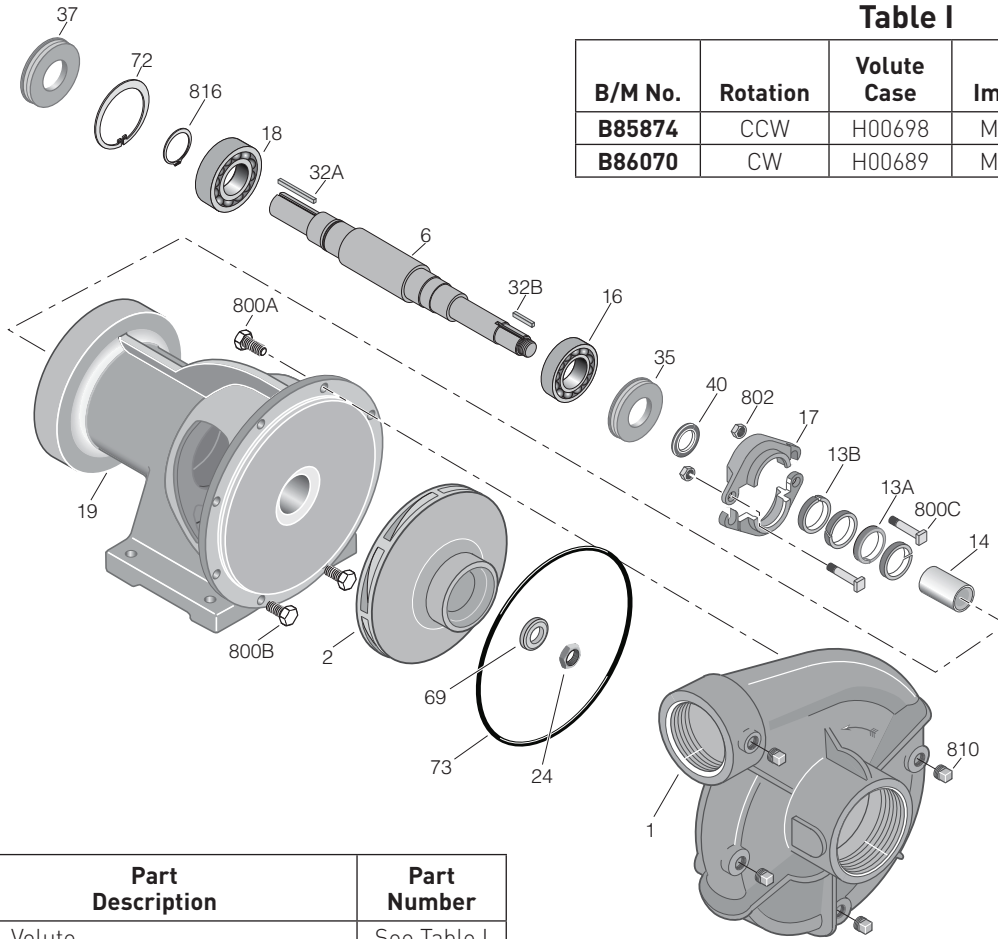

5790 0711

Item No.	Part Description	Part Number
1	Case, Volute	See Table I
2	Impeller	See Table I
6	Shaft	See Note 1
13A	Ring, Packing [3 Req.]	S08291
13B	Ring, Packing, Metallic	S11092
14	Sleeve, Shaft	M14993
16	Bearing, Ball	M14998
17	Gland, Packing	B82470
18	Bearing, Ball	M14999
19	Bearing Frame [Bracket]	M15690
24	Locknut, Impeller [CCW]	U36-189SS
24	Locknut, Impeller [CW]	M10220
32A	Key, 3/8"x3/8"x1-3/8"	M15001
32B	Key, 1/4x1/4"	S23505
35	Inner Bearing Cap	M14997
37	Outer Bearing Cap	M14996
40	Slinger, Water	S10964
69	Washer, Lock	M14990

Item No.	Part Description	Part Number
72	Ring, Thrust	S23025
73	O-Ring	M14943
800A	Capscrew, Hex 3/8-16x7/8" [6 Req.]	S26825
800B	Bolt, Sq. Head 3/8-16x1-1/8" [2 Req.]	S26827
800C	Bolt, Sq. Head 3/8-16x2-1/2" [2 Req.]	S23762
802	Nut, Hex 3/8-16 [2 Req.]	S23343
810	Plug, Pipe 1/4 NPT [3 Req.]	S23715
816	Ring, Retaining	M15000

**NOTE 1: Shaft Replacement Kit** available for this model. Berkeley part number **B85916** for CCW, **B85585** for CW. Pump Shaft sold in shaft replacement kit only.

